

038

Traffic Study Layout
Date of Study: Start 4/2/02
Time of Study: 11:00
24 Hour Study
Volume Study

Location: Golden Shadow West of Shadow Bend Place
PSL: 20 MPH
Key Map 217W
Weather: Sunny

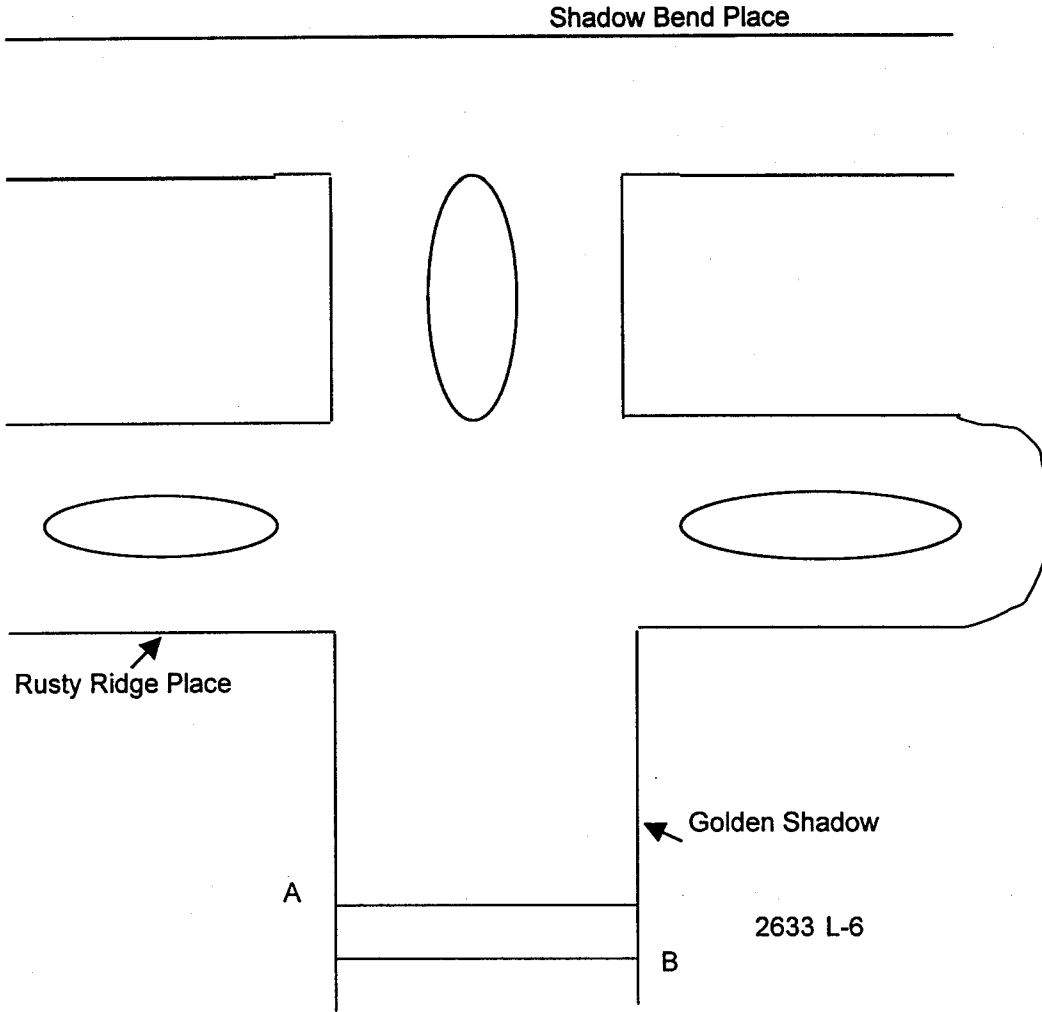

EAST
↑

SHADOW BEND PL.

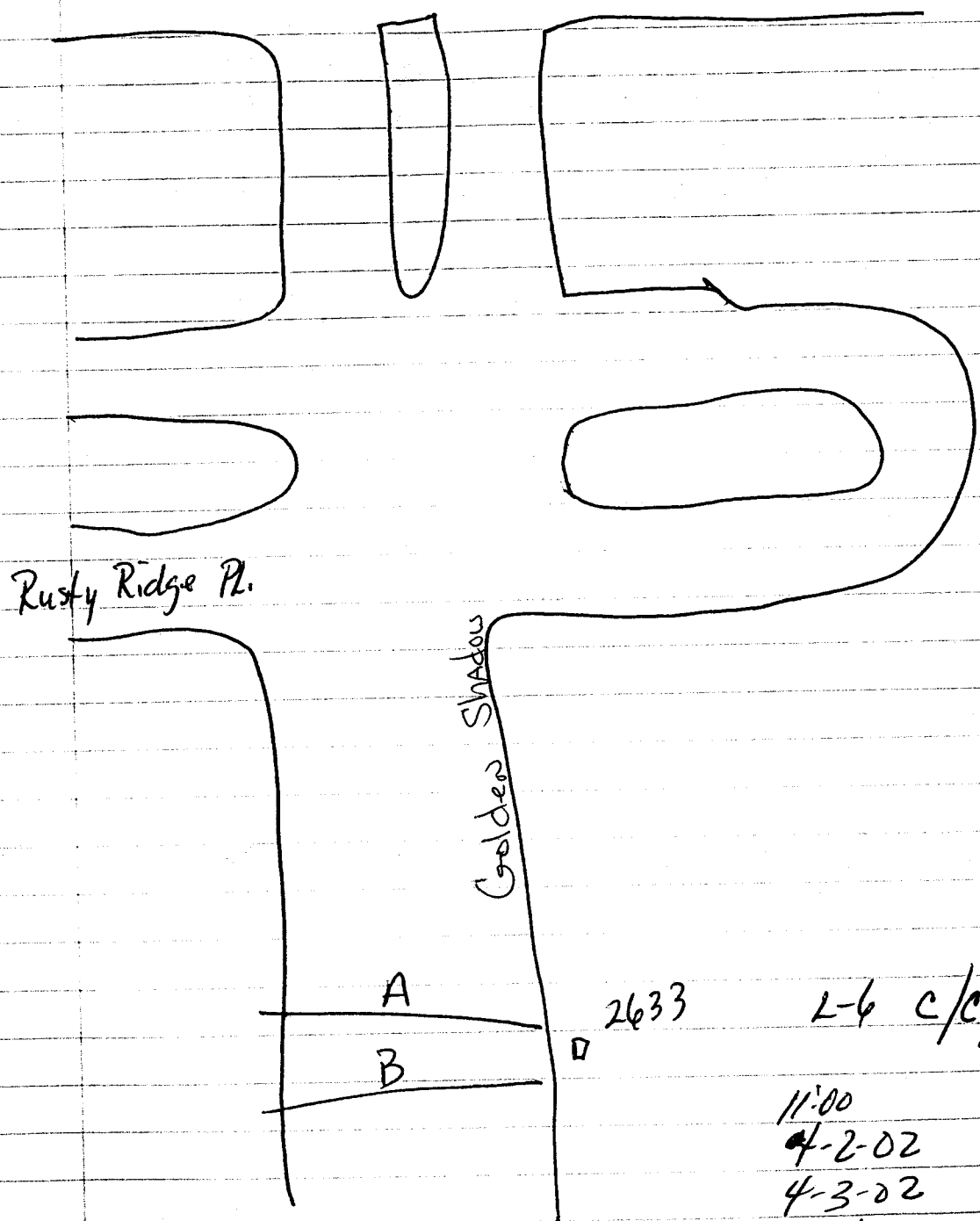

Rusty Ridge Pl.

Golden Shadow

A

B

2633

L-6 C/C/S

11:00

4-2-02

4-3-02

24 hrs.

Weather: SUNNY
 Channel: A WEST BOUND
 Channel: B EAST BOUND
 Layout: L-6 VOLUME STUDY 24 HR
 Street name :GOLDEN SHADOW WEST OF

Commissioner Ed Chance
 Montgomery County Precinct 3

Site Code : 00000002633
 Start Date: 04/02/2002
 File I.D. : UNTITLED
 Page : 1

Begin Time	Tues. 04/02		Wed. 04/03	
	Lane A	Lane B	Lane A	Lane B
12:00	*	*	3	0
1:00	*	*	0	1
2:00	*	*	1	0
03:00	*	*	0	1
04:00	*	*	3	8
05:00	*	*	7	43
06:00	*	*	25	125
07:00	*	*	57	192
08:00	*	*	83	133
09:00	*	*	67	78
10:00	*	*	60	89
11:00	71	80	*	*
12:00	99	69	*	*
01:00	86	93	*	*
02:00	125	90	*	*
03:00	143	122	*	*
04:00	131	98	*	*
05:00	167	118	*	*
06:00	194	122	*	*
07:00	134	77	*	*
08:00	96	45	*	*
09:00	70	25	*	*
10:00	31	12	*	*
11:00	9	5	*	*
Totals	1356	956	306	670
Day Totals		2312		976

AM Peaks	11:00	11:00	08:00	07:00
Volume	71	80	83	192
PM Peaks	06:00	03:00		
Volume	194	122		

MONTGOMERY COUNTY, TEXAS

DISCLAIMER

Montgomery County, Texas makes no guaranty on the accuracy of the counts herein contained. By use of the data contained in the traffic count report, the user agrees to hold harmless the county of Montgomery, including its officers and employees from any and all liabilities, claims, debts, damages, or actions of any kind arising from the use of this count data.

Begin Time	Total	0 - 15	16 - 20	21 - 25	26 - 30	31 - 35	36 - 40	41 - 45	46 - 50	51 - 55	56 - 60	61 - 65	66 - 70	71 - 75	76 - 999
12:00 04/02	*	*	*	*	*	*	*	*	*	*	*	*	*	*	*
01:00	*	*	*	*	*	*	*	*	*	*	*	*	*	*	*
02:00	*	*	*	*	*	*	*	*	*	*	*	*	*	*	*
03:00	*	*	*	*	*	*	*	*	*	*	*	*	*	*	*
04:00	*	*	*	*	*	*	*	*	*	*	*	*	*	*	*
05:00	*	*	*	*	*	*	*	*	*	*	*	*	*	*	*
06:00	*	*	*	*	*	*	*	*	*	*	*	*	*	*	*
07:00	*	*	*	*	*	*	*	*	*	*	*	*	*	*	*
08:00	*	*	*	*	*	*	*	*	*	*	*	*	*	*	*
09:00	*	*	*	*	*	*	*	*	*	*	*	*	*	*	*
10:00	*	*	*	*	*	*	*	*	*	*	*	*	*	*	*
11:00	80	0	3	13	38	24	2	0	0	0	0	0	0	0	0
12:00 pm	69	3	5	8	25	25	3	0	0	0	0	0	0	0	0
01:00	93	5	2	13	47	23	0	0	0	0	0	0	0	0	3
02:00	90	1	7	19	36	24	2	0	0	0	0	0	0	0	0
03:00	122	3	8	32	49	26	2	1	0	0	0	0	0	0	1
04:00	97	7	0	21	41	19	7	0	0	0	0	0	0	0	0
05:00	118	1	4	31	47	30	5	0	0	0	0	0	0	0	3
06:00	121	8	8	30	48	18	5	0	0	0	0	1	0	0	1
07:00	78	6	1	19	37	12	2	0	0	0	0	0	0	0	0
08:00	45	0	1	7	24	13	0	0	0	0	0	0	0	0	0
09:00	25	0	1	4	10	8	1	1	0	0	0	0	0	0	0
10:00	12	1	1	2	5	1	2	0	0	0	0	0	0	0	0
11:00	5	0	0	1	3	0	0	1	0	0	0	0	0	0	0
Day Totals	955	35	41	200	410	223	31	3	*	*	*	1	1	*	10
12:00 04/03	0	0	0	0	0	0	0	0	0	0	0	0	0	0	0
01:00	1	0	0	0	0	1	0	0	0	0	0	0	0	0	0
02:00	0	0	0	0	0	0	0	0	0	0	0	0	0	0	0
03:00	1	0	1	0	0	0	0	0	0	0	0	0	0	0	0
04:00	8	0	0	3	3	2	0	0	0	0	0	0	0	0	0
05:00	43	0	1	7	22	12	1	0	0	0	0	0	0	0	0
06:00	125	1	6	31	51	30	4	1	1	0	0	0	0	0	0
07:00	192	1	6	60	89	30	6	0	0	0	0	0	0	0	0
08:00	133	5	5	25	55	41	2	0	0	0	0	0	0	0	0
09:00	78	0	6	11	37	22	2	0	0	0	0	0	0	0	1
10:00	89	2	2	20	40	20	2	1	1	0	0	0	0	0	0
Grand Total	1625	44	68	357	707	381	48	5	2	0	0	1	1	0	11

Speed Statistics.

15th Percentile Speed : 21 MPH
 Median Speed (50th percentile): 27 MPH
 Average Speed - All Vehicles : 28 MPH
 85th Percentile Speed : 32 MPH
 95th Percentile Speed : 34 MPH
 10 MPH Pace Speed : 26-35 MPH
 Number of Vehicles in Pace : 1088
 Percent of Vehicles in Pace : 67.06%
 Number of Vehicles > 55 MPH : 13
 Percent of Vehicles > 55 MPH: .80%

MONTGOMERY COUNTY, TEXAS

DISCLAIMER

Montgomery County, Texas makes no guaranty on the accuracy of the counts herein contained. By use of the data contained in the traffic count report, the user agrees to hold harmless the county of Montgomery, including its officers and employees from any and all liabilities, claims, debts, damages, or actions of any kind arising from the use of this count data.

Weather: SUNNY
 Channel: A WEST BOUND
 24 HOUR STUDY
 Layout: L-6 SPEED STUDY PSL: 20 MPH

Commissioner Ed Chance
 Montgomery County Precinct 3

Site Code : 00000002633
 Start Date: 04/02/2002
 File I.D. : GOLDENSHAWDC
 Page : 1

Begin Time	Total	0 - 15	16 - 20	21 - 25	26 - 30	31 - 35	36 - 40	41 - 45	46 - 50	51 - 55	56 - 60	61 - 65	66 - 70	71 - 75	76 - 999
12:00 04/02	*	*	*	*	*	*	*	*	*	*	*	*	*	*	*
01:00	*	*	*	*	*	*	*	*	*	*	*	*	*	*	*
02:00	*	*	*	*	*	*	*	*	*	*	*	*	*	*	*
03:00	*	*	*	*	*	*	*	*	*	*	*	*	*	*	*
04:00	*	*	*	*	*	*	*	*	*	*	*	*	*	*	*
05:00	*	*	*	*	*	*	*	*	*	*	*	*	*	*	*
06:00	*	*	*	*	*	*	*	*	*	*	*	*	*	*	*
07:00	*	*	*	*	*	*	*	*	*	*	*	*	*	*	*
08:00	*	*	*	*	*	*	*	*	*	*	*	*	*	*	*
09:00	*	*	*	*	*	*	*	*	*	*	*	*	*	*	*
10:00	*	*	*	*	*	*	*	*	*	*	*	*	*	*	*
11:00	71	0	7	28	27	8	1	0	0	0	0	0	0	0	0
12:00 pm	99	1	12	36	37	13	0	0	0	0	0	0	0	0	0
01:00	86	0	7	28	39	12	0	0	0	0	0	0	0	0	0
02:00	125	2	12	48	47	15	1	0	0	0	0	0	0	0	0
03:00	143	3	16	59	47	15	3	0	0	0	0	0	0	0	0
04:00	131	4	15	38	55	17	2	0	0	0	0	0	0	0	0
05:00	167	2	9	60	68	23	1	1	0	0	0	0	0	0	0
06:00	194	1	15	75	75	21	3	0	1	0	0	0	0	0	2
07:00	134	0	5	45	68	15	0	1	0	0	0	0	0	0	0
08:00	96	2	6	38	38	10	2	0	0	0	0	0	0	0	0
09:00	70	1	6	28	28	5	2	0	0	0	0	0	0	0	0
10:00	31	1	1	11	14	2	2	0	0	0	0	0	0	0	0
11:00	9	0	1	4	2	1	0	0	0	0	0	0	0	0	0
Day Totals	1356	17	112	498	545	157	17	2	2	*	1	*	1	*	4
12:00 04/03	3	0	0	0	2	1	0	0	0	0	0	0	0	0	0
01:00	0	0	0	0	0	0	0	0	0	0	0	0	0	0	0
02:00	1	0	0	0	0	1	0	0	0	0	0	0	0	0	0
03:00	0	0	0	0	0	0	0	0	0	0	0	0	0	0	0
04:00	3	0	1	1	0	1	0	0	0	0	0	0	0	0	0
05:00	7	0	0	3	4	0	0	0	0	0	0	0	0	0	0
06:00	25	1	1	9	7	5	1	0	0	0	0	0	0	0	0
07:00	57	1	6	28	18	3	0	0	0	0	0	0	0	0	1
08:00	83	4	15	34	23	5	0	0	0	0	0	0	0	0	1
09:00	67	2	6	25	24	8	1	0	0	1	0	0	0	0	2
10:00	60	1	7	16	31	5	0	0	0	0	0	0	0	0	0
Grand Total	1662	26	148	614	654	186	19	2	2	1	1	0	1	0	8

Speed Statistics.

15th Percentile Speed : 20 MPH
 Median Speed (50th percentile): 25 MPH
 Average Speed - All Vehicles : 26 MPH
 85th Percentile Speed : 29 MPH
 95th Percentile Speed : 33 MPH
 10 MPH Pace Speed : 21-30 MPH
 Number of Vehicles in Pace : 1268
 Percent of Vehicles in Pace : 76.35%
 Number of Vehicles > 55 MPH : 10
 Percent of Vehicles > 55 MPH: .60%

MONTGOMERY COUNTY, TEXAS

DISCLAIMER

Montgomery County, Texas makes no guaranty on the accuracy of the counts herein contained. By use of the data contained in the traffic count report, the user agrees to hold harmless the county of Montgomery, including its officers and employees from any and all liabilities, claims, debts, damages, or actions of any kind arising from the use of this count data.

