

4037

Traffic Study Layout
Date of Study: Start 4/2/02
Time of Study: 11:00
24 Hour Study
Volume Study

Location: Golden Shadow North of Lake Woodlands
PSL: 20 MPH
Key Map
Weather: Sunny

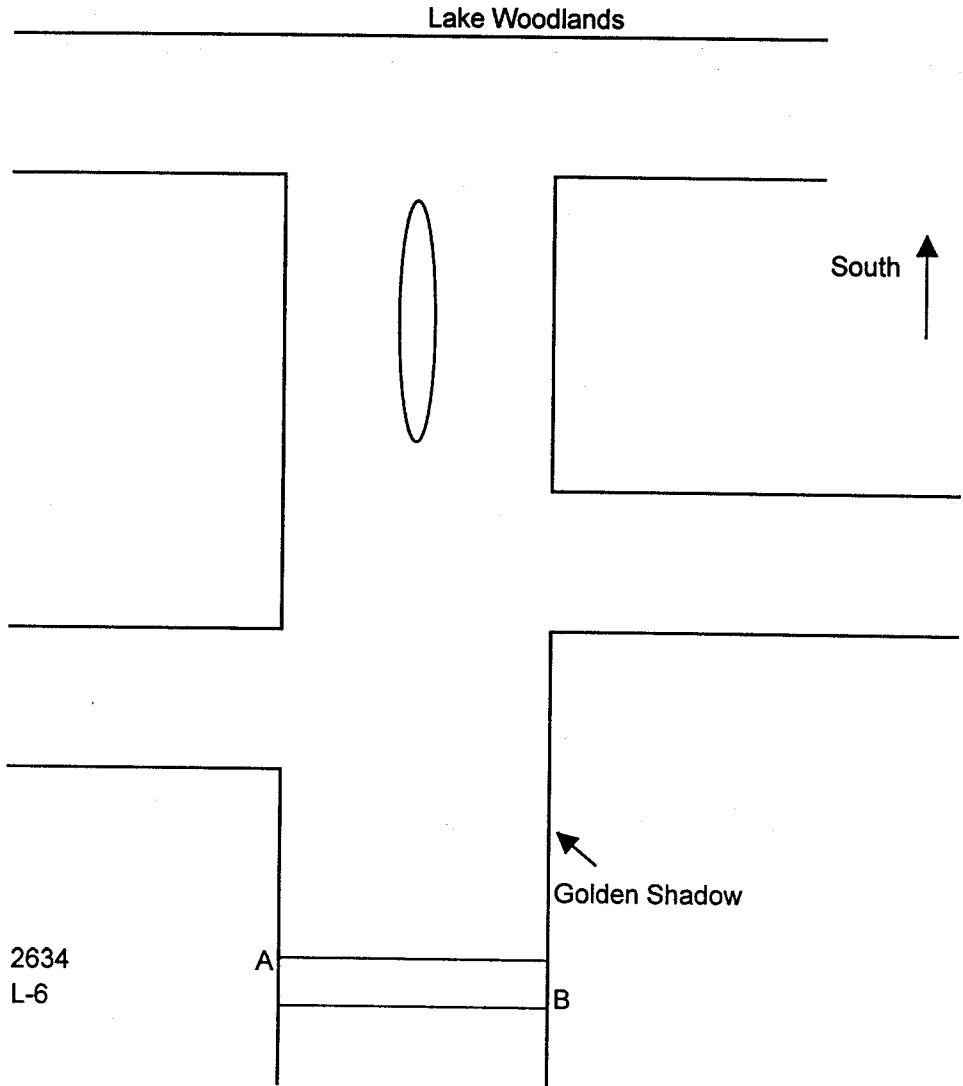

↑
South

LAKE WOODLANDS

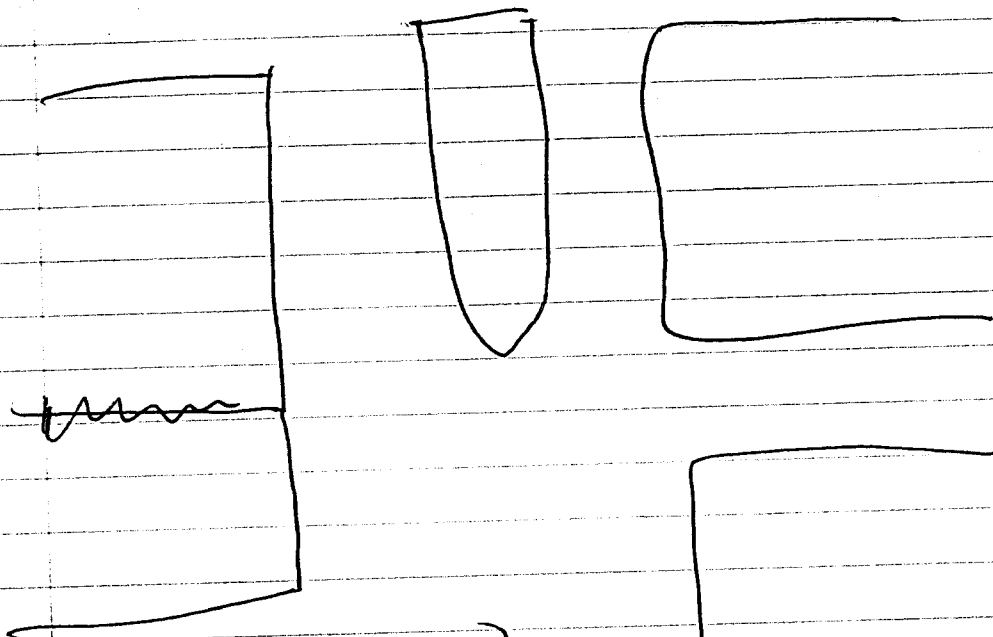

Golden Shadow

18/
Golden Shadow

2634

A

B

L-6 class/speed/count
11:00
4-2-02
4-3-02
24 hrs

Weather: SUNNY
 Channel: A NORTH BOUND
 Channel: B SOUTH BOUND
 Layout: L-6 VOLUME STUDY 24 HR

Commissioner Ed Chance
 Montgomery County Precinct 3

Site Code : 000000002634
 Start Date: 04/02/2002
 File I.D. : UNTITLED
 Page : 1

Street name :GOLDEN SHADOW NORTH OF Cross street:LAKE WOODLANDS ,

Begin Time	Tues. 04/02		Wed. 04/03	
	Lane A	Lane B	Lane A	Lane B
12:00	*	*	1	0
01:00	*	*	1	1
02:00	*	*	1	0
03:00	*	*	3	1
04:00	*	*	0	3
05:00	*	*	2	9
06:00	*	*	10	39
07:00	*	*	29	87
08:00	*	*	42	49
09:00	*	*	23	38
10:00	*	*	19	38
11:00	25	29	*	*
12:00	39	31	*	*
01:00	27	43	*	*
02:00	37	47	*	*
03:00	67	41	*	*
04:00	53	42	*	*
05:00	71	40	*	*
06:00	58	51	*	*
07:00	46	31	*	*
08:00	36	34	*	*
09:00	29	17	*	*
10:00	9	8	*	*
11:00	5	0	*	*
Totals	502	414	131	265
Day Totals		916		396

AM Peaks 11:00 11:00 08:00 07:00
 Volume 25 29 42 87

PM Peaks 05:00 06:00
 Volume 71 51

MONTGOMERY COUNTY, TEXAS

DISCLAIMER

Montgomery County, Texas makes no guaranty on the accuracy of the counts herein contained. By use of the data contained in the traffic count report, the user agrees to hold harmless the county of Montgomery, including its officers and employees from any and all liabilities, claims, debts, damages, or actions of any kind arising from the use of this count data.

Weather: SUNNY
 Channel: A NORTH BOUND
 24 HOUR STUDY
 Layout: L-6 SPEED STUDY

Commissioner Ed Chance
 Montgomery County Precinct 3

Site Code : 00000002634
 Start Date: 04/02/2002
 File I.D. : C:\PROGRAM F
 Page : 1

Begin Time	Total	0 - 15	16 - 20	21 - 25	26 - 30	31 - 35	36 - 40	41 - 45	46 - 50	51 - 55	56 - 60	61 - 65	66 - 70	71 - 75	76 - 999
12:00 04/02	*	*	*	*	*	*	*	*	*	*	*	*	*	*	*
1:00	*	*	*	*	*	*	*	*	*	*	*	*	*	*	*
2:00	*	*	*	*	*	*	*	*	*	*	*	*	*	*	*
03:00	*	*	*	*	*	*	*	*	*	*	*	*	*	*	*
04:00	*	*	*	*	*	*	*	*	*	*	*	*	*	*	*
05:00	*	*	*	*	*	*	*	*	*	*	*	*	*	*	*
06:00	*	*	*	*	*	*	*	*	*	*	*	*	*	*	*
07:00	*	*	*	*	*	*	*	*	*	*	*	*	*	*	*
08:00	*	*	*	*	*	*	*	*	*	*	*	*	*	*	*
09:00	*	*	*	*	*	*	*	*	*	*	*	*	*	*	*
10:00	*	*	*	*	*	*	*	*	*	*	*	*	*	*	*
11:00	25	1	5	5	14	0	0	0	0	0	0	0	0	0	0
12:00 pm	39	4	4	9	16	5	0	0	0	1	0	0	0	0	0
01:00	27	3	1	6	13	4	0	0	0	0	0	0	0	0	0
02:00	37	0	2	15	16	4	0	0	0	0	0	0	0	0	0
03:00	67	2	5	38	19	3	0	0	0	0	0	0	0	0	0
04:00	53	0	10	23	12	7	1	0	0	0	0	0	0	0	0
05:00	71	0	4	25	35	6	0	0	0	0	0	0	0	0	1
06:00	58	0	4	15	35	3	1	0	0	0	0	0	0	0	0
07:00	46	1	2	20	18	4	1	0	0	0	0	0	0	0	0
08:00	36	1	2	10	14	5	4	0	0	0	0	0	0	0	0
09:00	30	1	3	12	8	4	2	0	0	0	0	0	0	0	0
10:00	9	0	0	4	4	1	0	0	0	0	0	0	0	0	0
11:00	5	1	0	3	1	0	0	0	0	0	0	0	0	0	0
Day Totals	503	14	42	185	205	46	9	*	*	1	*	*	*	*	1
12:00 04/03	1	1	0	0	0	0	0	0	0	0	0	0	0	0	0
01:00	1	0	0	1	0	0	0	0	0	0	0	0	0	0	0
02:00	1	0	0	0	1	0	0	0	0	0	0	0	0	0	0
03:00	3	0	1	1	1	0	0	0	0	0	0	0	0	0	0
04:00	0	0	0	0	0	0	0	0	0	0	0	0	0	0	0
05:00	2	1	0	0	0	0	1	0	0	0	0	0	0	0	0
06:00	10	0	0	4	4	1	1	0	0	0	0	0	0	0	0
07:00	29	0	3	9	13	4	0	0	0	0	0	0	0	0	0
08:00	43	3	6	22	9	2	0	0	0	0	0	0	0	0	1
09:00	24	4	4	7	7	2	0	0	0	0	0	0	0	0	0
10:00	19	3	4	8	2	1	1	0	0	0	0	0	0	0	0
Grand Total	636	26	60	237	242	56	12	0	0	1	0	0	0	0	2

Speed Statistics.
 15th Percentile Speed : 20 MPH
 Median Speed (50th percentile): 24 MPH
 Average Speed - All Vehicles : 25 MPH
 85th Percentile Speed : 29 MPH
 95th Percentile Speed : 33 MPH
 10 MPH Pace Speed : 21-30 MPH
 Number of Vehicles in Pace : 479
 Percent of Vehicles in Pace : 75.41%
 Number of Vehicles > 55 MPH : 2
 Percent of Vehicles > 55 MPH: .31%

MONTGOMERY COUNTY, TEXAS

DISCLAIMER

Montgomery County, Texas makes no guaranty on the accuracy of the counts herein contained. By use of the data contained in the traffic count report, the user agrees to hold harmless the county of Montgomery, including its officers and employees from any and all liabilities, claims, debts, damages, or actions of any kind arising from the use of this count data.

Weather: SUNNY
 Channel: B SOUTH BOUND
 24 HOUR STUDY

Commissioner Ed Chance
 Montgomery County Precinct 3

Site Code : 00000002634
 Start Date: 04/02/2002
 File I.D. : C:\PROGRAM F
 Page : 1

Layout: L-6 SPEED STUDY PSL: 20 MPH

Street name :GOLDEN SHADOW NORTH OF Cross street:LAKE WOODLANDS B to A

Begin Time	Total	0 - 15	16 - 20	21 - 25	26 - 30	31 - 35	36 - 40	41 - 45	46 - 50	51 - 55	56 - 60	61 - 65	66 - 70	71 - 75	76 - 999
12:00 04/02	*	*	*	*	*	*	*	*	*	*	*	*	*	*	*
1:00	*	*	*	*	*	*	*	*	*	*	*	*	*	*	*
2:00	*	*	*	*	*	*	*	*	*	*	*	*	*	*	*
03:00	*	*	*	*	*	*	*	*	*	*	*	*	*	*	*
04:00	*	*	*	*	*	*	*	*	*	*	*	*	*	*	*
05:00	*	*	*	*	*	*	*	*	*	*	*	*	*	*	*
06:00	*	*	*	*	*	*	*	*	*	*	*	*	*	*	*
07:00	*	*	*	*	*	*	*	*	*	*	*	*	*	*	*
08:00	*	*	*	*	*	*	*	*	*	*	*	*	*	*	*
09:00	*	*	*	*	*	*	*	*	*	*	*	*	*	*	*
10:00	*	*	*	*	*	*	*	*	*	*	*	*	*	*	*
11:00	29	0	6	7	13	3	0	0	0	0	0	0	0	0	0
12:00 pm	31	1	0	11	15	4	0	0	0	0	0	0	0	0	0
01:00	43	1	4	5	28	5	0	0	0	0	0	0	0	0	0
02:00	47	0	5	9	16	14	3	0	0	0	0	0	0	0	0
03:00	42	3	3	16	14	5	0	0	0	0	0	0	0	0	0
04:00	43	3	1	9	22	6	1	0	0	0	0	0	0	0	0
05:00	40	0	3	15	18	3	0	0	0	0	0	0	0	0	0
06:00	51	1	10	15	18	6	1	0	0	0	0	0	0	0	0
07:00	31	3	3	8	8	8	1	0	0	0	0	0	0	0	0
08:00	34	1	0	16	9	8	0	0	0	0	0	0	0	0	0
09:00	18	0	4	2	2	6	1	0	1	0	0	0	0	0	0
10:00	8	0	0	3	3	1	1	0	0	0	0	0	0	0	0
11:00	0	0	0	0	0	0	0	0	0	0	0	0	0	0	0
Day Totals	417	13	39	116	166	69	8	*	1	*	*	*	*	*	5
12:00 04/03	0	0	0	0	0	0	0	0	0	0	0	0	0	0	0
01:00	1	0	1	0	0	0	0	0	0	0	0	0	0	0	0
02:00	0	0	0	0	0	0	0	0	0	0	0	0	0	0	0
03:00	1	0	0	1	0	0	0	0	0	0	0	0	0	0	0
04:00	3	0	0	0	3	0	0	0	0	0	0	0	0	0	0
05:00	9	0	1	4	1	2	1	0	0	0	0	0	0	0	0
06:00	39	2	2	6	18	11	0	0	0	0	0	0	0	0	0
07:00	87	2	5	19	46	15	0	0	0	0	0	0	0	0	0
08:00	50	3	6	9	22	6	4	0	0	0	0	0	0	0	0
09:00	38	12	2	7	14	2	1	0	0	0	0	0	0	0	0
10:00	38	2	4	17	12	2	1	0	0	0	0	0	0	0	0
Grand Total	683	34	60	179	282	107	15	0	1	0	0	0	0	0	5

Speed Statistics.

15th Percentile Speed : 20 MPH
 Median Speed (50th percentile): 26 MPH
 Average Speed - All Vehicles : 27 MPH
 85th Percentile Speed : 31 MPH
 95th Percentile Speed : 34 MPH
 10 MPH Pace Speed : 21-30 MPH
 Number of Vehicles in Pace : 461
 Percent of Vehicles in Pace : 67.64%
 Number of Vehicles > 55 MPH : 5
 Percent of Vehicles > 55 MPH: .73%

MONTGOMERY COUNTY, TEXAS

DISCLAIMER

Montgomery County, Texas makes no guaranty on the accuracy of the counts herein contained. By use of the data contained in the traffic count report, the user agrees to hold harmless the county of Montgomery, including its officers and employees from any and all liabilities, claims, debts, damages, or actions of any kind arising from the use of this count data.