

0024

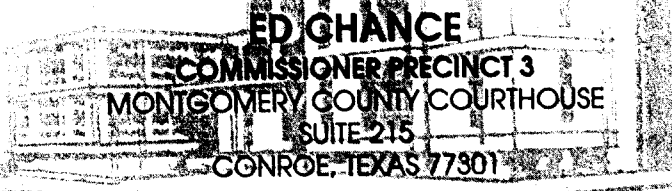

Address:
1130 Pruitt Road
Spring, Texas 77380
e-mail: echance@co.montgomery.tx.us

Conroe: (936) 539-7817
Houston: (281) 367-3977
Fax: (281) 298-7321

Traffic Study: 05/15/02 to 05/16/02 24-hour study
Location: Butera @ Indigo Ranch (Private)
Magnolia, Texas

Weather: Sunny
Start Time: 13:00
End Time: 13:00
Layout: L3
Key map: 246T

Traffic Study Layout
Start date: 5/15/02
End date: 5/16/02
Start time: 13:00
End time: 13:00
24 Hour Study
Basic Volume Study

Location: Butera @ Indigo Ranch (Private)
PSL:
Key Map 246T
Weather: Sunny

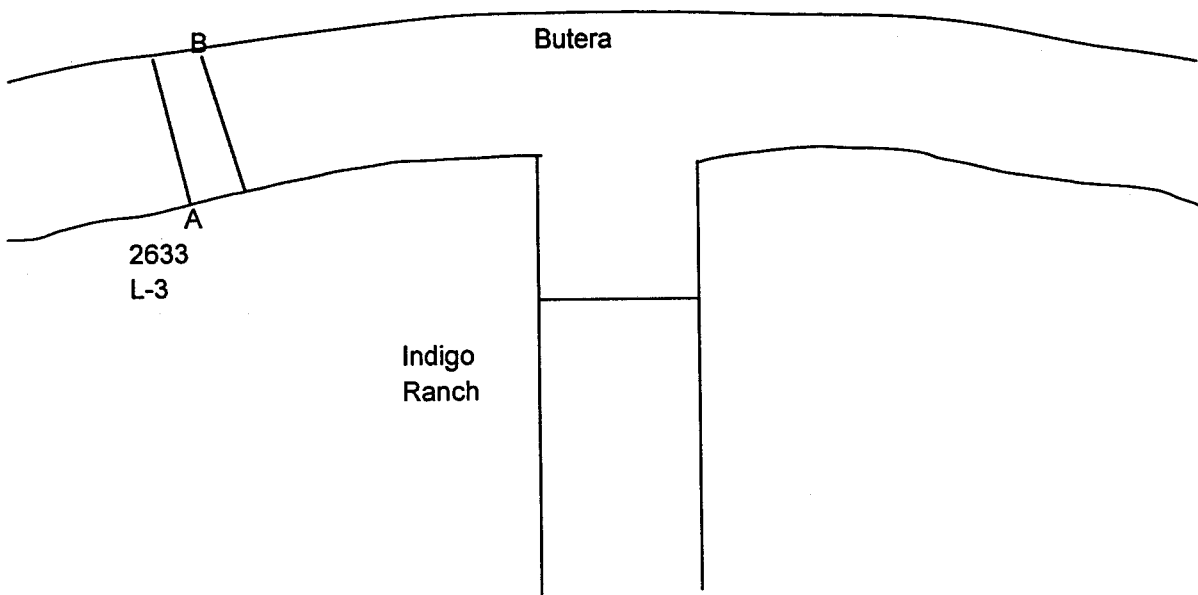

Weather: SUNNY
 Channel A/R: EAST BOUND
 Channel B/A: WEST BOUND
 Layout: L-3 BASIC VOLUME 24 HR.
 Street name : BUTERA WEST OF

Commissioner Ed Chance
 Montgomery County Precinct 3

Site Code : 0000000263
 Start Date: 05/15/2002
 File I.D. : BUTERA/BASIC
 Page : 1

Begin Time	Wed. 05/15		Thur. 05/16	
	Ch. A/B	B/A	Ch. A/B	B/A
12:00	*	*	4	23
01:00	*	*	1	18
02:00	*	*	0	13
03:00	*	*	0	9
04:00	*	*	0	43
05:00	*	*	26	132
06:00	*	*	6	317
07:00	*	*	93	388
08:00	*	*	53	262
09:00	*	*	4	186
10:00	*	*	12	182
11:00	*	*	22	159
12:00	*	*	13	184
01:00	12	192	0	0
02:00	13	264	*	*
03:00	14	300	*	*
04:00	29	338	*	*
05:00	23	443	*	*
06:00	40	386	*	*
07:00	18	284	*	*
08:00	25	218	*	*
09:00	10	176	*	*
10:00	7	96	*	*
11:00	2	50	*	*
Totals	193	2747	234	1916
Day Totals		2940		2150

AM Peaks		07:00	07:00
Volume		93	388
PM Peaks	06:00	05:00	12:00
Volume	40	443	13

MONTGOMERY COUNTY, TEXAS

DISCLAIMER

Montgomery County, Texas makes no guaranty on the accuracy of the counts herein contained. By use of the data contained in the traffic count report, the user agrees to hold harmless the county of Montgomery, including its officers and employees from any and all liabilities, claims, debts, damages, or actions of any kind arising from the use of this count data.